

PRIME RETAIL SPACE NEXT TO MATTRESS FIRM

2839 NW Federal Highway, Stuart FL 34994

1,513 SF
LAST SPACE AVAILABLE!



FOR LEASE | \$29.95/sf NNN

Jeremiah Baron
& CO.

Commercial Real Estate, LLC

49 SW Flagler Ave. Suite 301

Stuart FL, 34994

www.commercialrealestatellc.com

Matthew Mondo

772.286.5744 Office

772.236.7780 Mobile

mmondo@commercialrealestatellc.com

PROPERTY OVERVIEW

- **LAST SPACE AVAILABLE!** Exceptional retail space located in the Mattress Firm anchored strip center across from the Treasure Coast Mall.
- Spacious open floor concept site ideal for a wide range of retail uses or services; ample room for merchandise display.
- Neighboring tenants include: Mattress Firm, Jenny Craig, and Sage Dental.
- High traffic area with a little over 200 ft. of frontage and surrounded by many National and regional brands.
- Other features include highly visible monument and plenty of parking.



LEASE RATE	\$29.95/sf NNN
SPACE AVAILABLE	1,513 SF
BUILDING SIZE	8,165 SF
BUILDING TYPE	Retail
ACREAGE	1.35 AC
FRONTAGE	212'
TRAFFIC COUNT	56,000 ADT
YEAR BUILT	2008
CONSTRUCTION TYPE	Concrete
PARKING SPACE	30+ parking in the back
ZONING	CG - Commercial General
LAND USE	Commercial General
PARCEL ID	19-37-41-000-000450-1

NO WARRANTY OR REPRESENTATION, EXPRESS OR IMPLIED, IS MADE AS TO THE ACCURACY OF THE INFORMATION CONTAINED HEREIN, AND THE SAME IS SUBMITTED SUBJECT TO ERRORS, OMISSIONS, CHANGE OF PRICE, RENTAL OR OTHER CONDITIONS, PRIOR SALE, LEASE OR FINANCING, OR WITHDRAWAL WITHOUT NOTICE, AND OF ANY SPECIAL LISTING CONDITIONS IMPOSED BY OUR PRINCIPALS NO WARRANTIES OR REPRESENTATIONS ARE MADE AS TO THE CONDITION OF THE PROPERTY OR ANY HAZARDS CONTAINED THEREIN ARE ANY TO BE IMPLIED.

**Jeremiah Baron
& CO.**

Commercial Real Estate, LLC

49 SW Flagler Ave. Suite 301
Stuart FL, 34994
www.commercialrealestatellc.com

Matthew Mondo
772.286.5744 Office
772.236.7780 Mobile
mmondo@commercialrealestatellc.com

INTERIOR PHOTOS



**Jeremiah Baron
& CO.**

Commercial Real Estate, LLC

49 SW Flagler Ave. Suite 301

Stuart FL, 34994

www.commercialrealestatellc.com

Matthew Mondo

772.286.5744 Office

772.236.7780 Mobile

mmondo@commercialrealestatellc.com

DEMOGRAPHICS

2021 Population Estimate		2021 Average Household Income		Average Age	
1 Mile	5,046	1 Mile	\$99,901	1 Mile	44.50
3 Mile	36,840	3 Mile	\$90,054	3 Mile	46.70
5 Mile	108,616	5 Mile	\$84,693	5 Mile	48.60
2026 Population Projection		2021 Median Household Income		Median Age	
1 Mile	5,166	1 Mile	\$77,227	1 Mile	47.30
3 Mile	38,648	3 Mile	\$71,435	3 Mile	51.00
5 Mile	115,516	5 Mile	\$65,819	5 Mile	53.30

Jeremiah Baron
& CO.

Commercial Real Estate, LLC

49 SW Flagler Ave. Suite 301
Stuart FL, 34994
www.commercialrealestatellc.com

Matthew Mondo
772.286.5744 Office
772.236.7780 Mobile
mmondo@commercialrealestatellc.com

ZONING INFORMATION

CG - Commercial General - Martin County

<i>Commercial and Business Uses</i>	GC
Adult business	
Ancillary retail use	
Bed and breakfast inns	
Business and professional offices	P
Campgrounds	
Commercial amusements, indoor	P
Commercial amusements, outdoor	P
Commercial day care	P
Construction industry trades	P
Construction sales and services	P
Family day care	
Financial institutions	P
Flea markets	P
Funeral homes	P
General retail sales and services	P
Golf courses	
Golf driving ranges	P
Hotels, motels, resorts and spas	P
Kennels, commercial	P
Limited retail sales and services	P

Marinas, commercial	P
Marine education and research	
Medical services	P
Pain management clinics	P
Parking lots and garages	P
Recreational vehicle parks	P
Recreational vehicle parks, limited to the number and configuration of units lawfully established prior to the effective date of this ordinance	
Residential storage facilities	P
Restaurants, convenience, with drive-through facilities	P
Restaurants, convenience, without drive-through facilities	P
Restaurants, general	P
Shooting ranges	
Shooting ranges, indoor	P
Shooting ranges, outdoor	
Trades and skilled services	P
Vehicular sales and service	P
Vehicular service and maintenance	P
Veterinary medical services	P
Wholesale trades and services	P

**Jeremiah Baron
& CO.**

Commercial Real Estate, LLC

49 SW Flagler Ave. Suite 301

Stuart FL, 34994

www.commercialrealestatellc.com

Matthew Mondo

772.286.5744 Office

772.236.7780 Mobile

mmondo@commercialrealestatellc.com

SITE PLAN

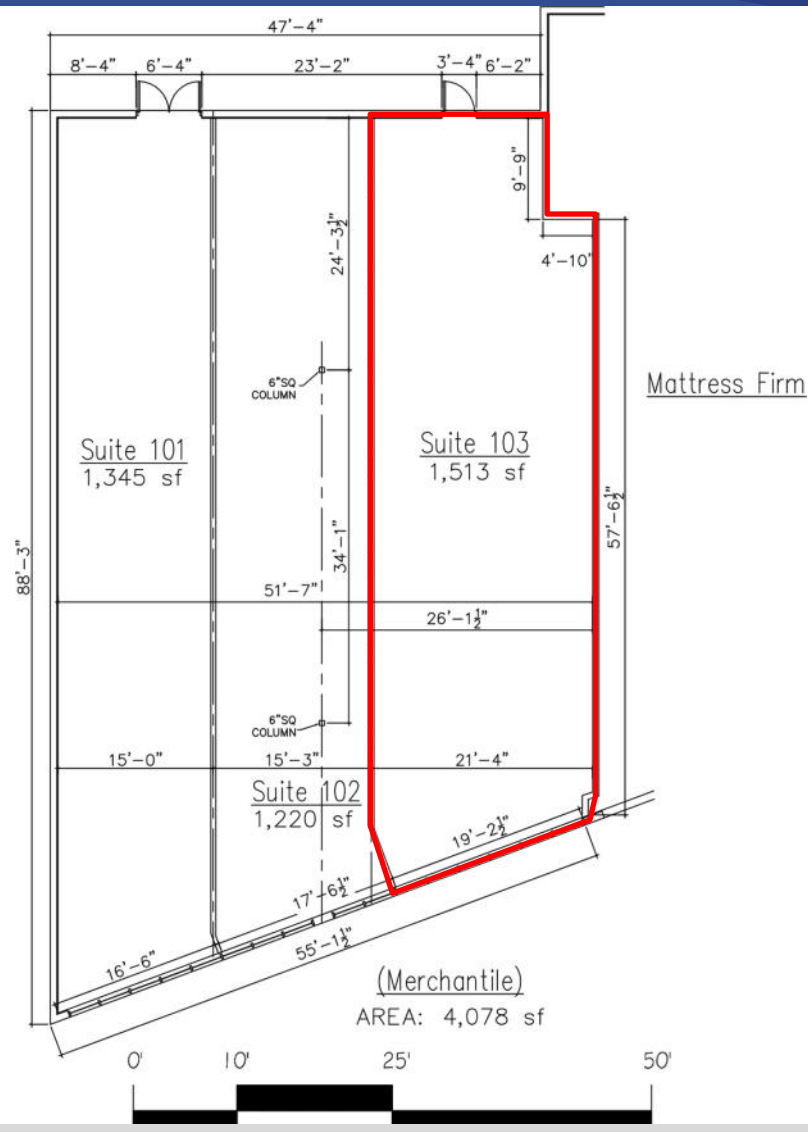

**Jeremiah Baron
& CO.**

Commercial Real Estate, LLC

49 SW Flagler Ave. Suite 301
Stuart FL, 34994
www.commercialrealestatellc.com

Matthew Mondo
772.286.5744 Office
772.236.7780 Mobile
mmondo@commercialrealestatellc.com

TRADE AREA MAP



**Jeremiah Baron
& CO.**

Commercial Real Estate, LLC

49 SW Flagler Ave. Suite 301
Stuart FL, 34994
www.commercialrealestatellc.com

Matthew Mondo
772.286.5744 Office
772.236.7780 Mobile
mmondo@commercialrealestatellc.com