

# FREESTANDING RETAIL BUILDING

4141 S US Highway 1, Fort Pierce 34982



FOR SALE | \$845,000

**Jeremiah Baron**  
& CO.

Commercial Real Estate, LLC

49 SW Flagler Ave. Suite 301  
Stuart FL, 34994  
[www.commercialrealestatellc.com](http://www.commercialrealestatellc.com)

**Brian Schwan**  
772.286.5744 Office  
772.215.1167 Mobile  
[bschwan@commercialrealestatellc.com](mailto:bschwan@commercialrealestatellc.com)

**Conor Mackin**  
772.286.5744 Office  
973.303.1160 Mobile  
[cmackin@commercialrealestatellc.com](mailto:cmackin@commercialrealestatellc.com)

# PROPERTY OVERVIEW

- Excellent freestanding retail building with an operating motorcycle business that offers sales and repair services.
- Building features a showroom area, office, and fenced storage in the rear. Front doors and windows are equipped with accordion storm shutters.
- Great owner/user opportunity with an established franchise business in place.
- Great exposure to US-1 which receives high traffic counts and surrounded by National and regional brands such as Jetson TV and Appliance and multiple auto dealerships.



PRICE	\$845,000
BUILDING SIZE	4,379 SF
BUILDING TYPE	Auto Service
ACREAGE	0.36 AC
FRONTAGE	138'
TRAFFIC COUNT	41,500 ADT
YEAR BUILT	1978
CONSTRUCTION TYPE	CBS
ZONING	C-3 (Ft. Pierce)
LAND USE	CC
PARCEL ID	2434-314-0002-010-0

NO WARRANTY OR REPRESENTATION, EXPRESS OR IMPLIED, IS MADE AS TO THE ACCURACY OF THE INFORMATION CONTAINED HEREIN, AND THE SAME IS SUBMITTED SUBJECT TO ERRORS, OMISSIONS, CHANGE OF PRICE, RENTAL OR OTHER CONDITIONS, PRIOR SALE, LEASE OR FINANCING, OR WITHDRAWAL WITHOUT NOTICE, AND OF ANY SPECIAL LISTING CONDITIONS IMPOSED BY OUR PRINCIPALS NO WARRANTIES OR REPRESENTATIONS ARE MADE AS TO THE CONDITION OF THE PROPERTY OR ANY HAZARDS CONTAINED THEREIN ARE ANY TO BE IMPLIED.

**Jeremiah Baron  
& CO.**  
Commercial Real Estate, LLC

49 SW Flagler Ave. Suite 301  
Stuart FL, 34994  
[www.commercialrealestatellc.com](http://www.commercialrealestatellc.com)

**Brian Schwan**  
772.286.5744 Office  
772.215.1167 Mobile  
[bschwan@commercialrealestatellc.com](mailto:bschwan@commercialrealestatellc.com)

**Conor Mackin**  
772.286.5744 Office  
973.303.1160 Mobile  
[cmackin@commercialrealestatellc.com](mailto:cmackin@commercialrealestatellc.com)

# DEMOGRAPHICS

2021 Population Estimate		2021 Average Household Income		Average Age	
1 Mile	3,849	1 Mile	\$59,456	1 Mile	42.20
3 Mile	28,803	3 Mile	\$59,394	3 Mile	40.80
5 Mile	86,004	5 Mile	\$61,522	5 Mile	41.30

2026 Population Projection		2021 Median Household Income		Median Age	
1 Mile	4,129	1 Mile	\$47,018	1 Mile	43.20
3 Mile	30,741	3 Mile	\$45,847	3 Mile	40.70
5 Mile	93,259	5 Mile	\$46,606	5 Mile	41.40

**Jeremiah Baron  
& CO.**

**Commercial Real Estate, LLC**

49 SW Flagler Ave. Suite 301  
Stuart FL, 34994  
[www.commercialrealestatellc.com](http://www.commercialrealestatellc.com)

**Brian Schwan**  
772.286.5744 Office  
772.215.1167 Mobile  
[bschwan@commercialrealestatellc.com](mailto:bschwan@commercialrealestatellc.com)

**Conor Mackin**  
772.286.5744 Office  
973.303.1160 Mobile  
[cmackin@commercialrealestatellc.com](mailto:cmackin@commercialrealestatellc.com)

# ZONING INFORMATION

## Sec. 22-31. - General Commercial Zone (C-3).

(a) Purpose. The district is intended to provide for a broad variety of business activities including shoppers' goods stores, convenience goods and service establishments, offices and tourist/entertainment facilities. Many public and semi-public uses are also appropriate. Compared to the C-4 zone, this district is more suitable for uses requiring a high degree of accessibility to vehicular traffic, low intensity uses on large tracts of land, most repair services and small warehousing and wholesaling operations. Although this zone should be located along or near arterial or collector streets, it is not the intent of this district to encourage the extension of strip commercial areas. Instead it should promote concentrations of commercial activities.

(b) Basic use standards. Uses in a C-3 zone must meet the requirements of this section. More restrictive requirements, set forth in accordance with other provisions of this chapter, must be satisfied by some conditional uses.

- (1) Lot size.
  - a. The minimum lot area shall be ten thousand (10,000) square feet.
  - b. The minimum lot width shall be seventy (70) feet.
  - c. The minimum lot depth shall be ninety (90) feet.
- (2) Yards.
  - a. The minimum depth of the front yard will be twenty-five (25) feet.
  - b. The minimum yard depth (if not the front yard) for portions of the property abutting a public right-of-way or residential district shall be fifteen (15) feet.
- (3) Lot coverage. Buildings shall not cover more than sixty (60) per cent of the lot area.
- (4) Building height. No building shall exceed a height of sixty-five (65) feet above grade, except that multifamily developments in accordance with the requirements of the R-5 zone may be approved.
  - (c) Other applicable use standards.
- (1) Site plan review shall be required as outlined in section 22-58.
  - (2) Accessory buildings shall comply with all yard, lot coverage and building height requirements of this chapter.
  - (3) Every lot shall abut a street other than an alley for at least fifty (50) feet.
  - (4) Materials or objects which would detract from the open space character of an uncovered or unenclosed area will not be permitted in such an area.
  - (5) All uses will comply with applicable access, parking and loading standards in sections 22-60 and 22-61.
  - (6) Conditional uses will meet the requirements in sections 22-74 through 22-86.
  - (7) Signs will comply with standards referred to in section 22-55.
  - (8) All other applicable ordinance requirements will also be satisfied.
  - (9) An adult establishment is not permitted in C-3 unless the adult establishment is at least:
    - a. One thousand (1,000) feet from any other adult establishment:
    - b. Four hundred (400) feet from any established church, public or private school, public playground or public park;
    - c. Four hundred (400) feet from any areas zoned E-1, R-1, R-2, R-3, R-4, or R-5.
  - (10) For purposes of the distance limitations contained in subsection (e)(9) above, the measurement shall be made by extending a straight line from the main entrance of the building of the adult establishment to the:
    - a. Front door of the main building occupied by any other adult establishment or any established church; or
    - b. To the nearest property line of any residential district, playground, school or park.

**Jeremiah Baron  
& CO.**

**Commercial Real Estate, LLC**

49 SW Flagler Ave. Suite 301  
Stuart FL, 34994  
www.commercialrealestatellc.com

**Brian Schwan**  
772.286.5744 Office  
772.215.1167 Mobile  
bschwan@commercialrealestatellc.com

**Conor Mackin**  
772.286.5744 Office  
973.303.1160 Mobile  
cmackin@commercialrealestatellc.com

# FLOOR SKETCH

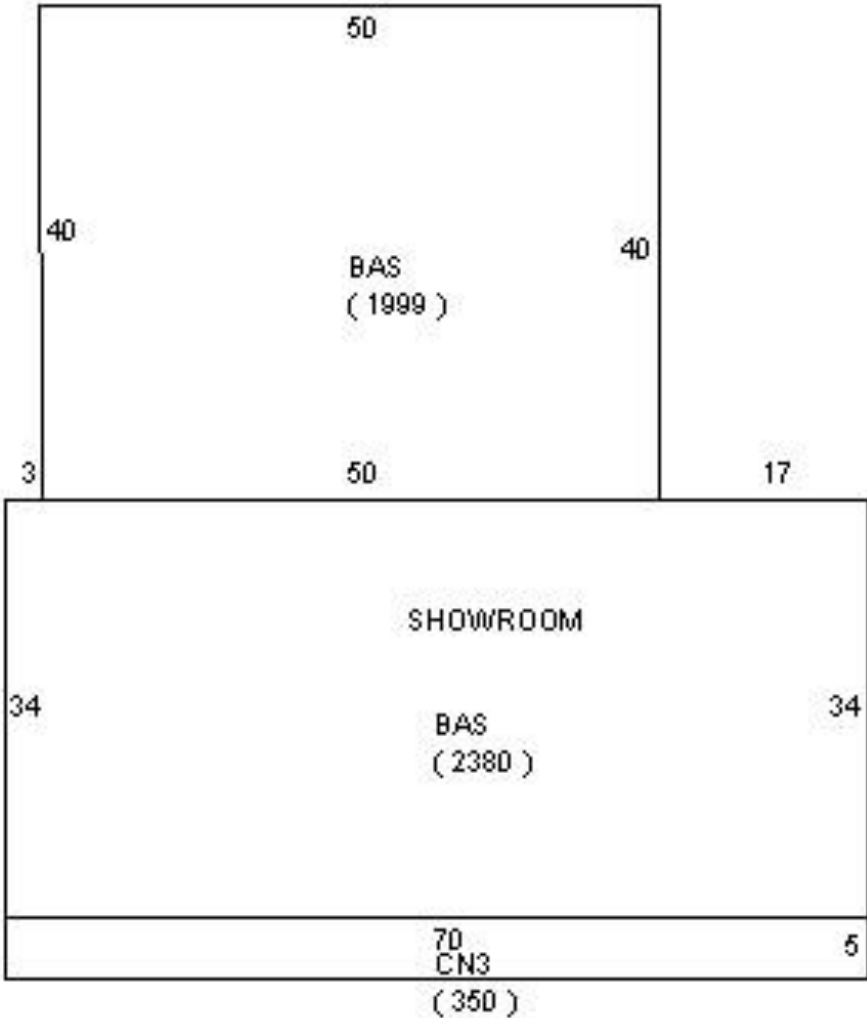

# TRADE AREA MAP



**Jeremiah Baron  
& CO.**

**Commercial Real Estate, LLC**

49 SW Flagler Ave. Suite 301  
Stuart FL, 34994  
[www.commercialrealestatellc.com](http://www.commercialrealestatellc.com)

**Brian Schwan**  
772.286.5744 Office  
772.215.1167 Mobile  
[bschwan@commercialrealestatellc.com](mailto:bschwan@commercialrealestatellc.com)

**Conor Mackin**  
772.286.5744 Office  
973.303.1160 Mobile  
[cmackin@commercialrealestatellc.com](mailto:cmackin@commercialrealestatellc.com)