



OFFICE / WAREHOUSE SPACE(S)
COMMERCE PARK | ST LUCIE WEST

660 NW PEACOCK BLVD. PORT ST. LUCIE FL, 34986

**JEREMIAH BARON
& CO**

COMMERCIAL REAL ESTATE



OFFICE/WARHOUSE SPACE(S) ST. LUCIE WEST

PRESENTED BY:

Janine Landolina

Commercial Agent

2100 SE Ocean Blvd. Suite 100 | Stuart, FL 34996

P: 772.285.2599

E: ileaseit@gmail.com

FL License No. SL3094598

**JEREMIAH BARON
& CO**

COMMERCIAL REAL ESTATE

NO WARRANTY OR REPRESENTATION, EXPRESS OR IMPLIED, IS MADE AS TO THE ACCURACY OF THE INFORMATION CONTAINED HEREIN, AND THE SAME IS SUBMITTED SUBJECT TO ERRORS, OMISSIONS, CHANGE OF PRICE, RENTAL OR OTHER CONDITIONS, PRIOR SALE, LEASE OR FINANCING, OR WITHDRAWAL WITHOUT NOTICE, AND OF ANY SPECIAL LISTING CONDITIONS IMPOSED BY OUR PRINCIPALS NO WARRANTIES OR REPRESENTATIONS ARE MADE AS TO THE CONDITION OF THE PROPERTY OR ANY HAZARDS CONTAINED THEREIN ARE ANY TO BE IMPLIED.

PROPERTY DETAILS

660 NW PEACOCK BLVD. PORT ST. LUCIE FL, 34986

LEASE RATE	\$10.50/SF NNN
BUILDING SIZE	54,646 SF
SPACE(S) AVAILABLE	10,711 SF
ACREAGE	3.13 AC
FRONTAGE	346'
TRAFFIC COUNT	15,300 ADT
ZONING	Warehouse Industrial (PSL)
LAND USE	LI / CS
PARCEL ID	3323-640-0004-000-5

- **LAST SPACE AVAILABLE!**
- 56,642 SF freestanding building on 3.13 acres located along Peacock Blvd. in the heart of the thriving industrial district of St. Lucie West.
- This warehouse/office space is being offered with new HVAC systems, new bathrooms, and office flooring.
- Streamline your operations with the convenience of two (2) 12' x 14' grade level roll up doors, 3,000 amps of three-phase electric service, generous ceiling height of 21', and a loft/storage area.
- Enjoy seamless connectivity with easy access to I-95 and other major highways.



FLOOR PLAN

FIRST FLOOR PLANS



SECOND FLOOR PLANS

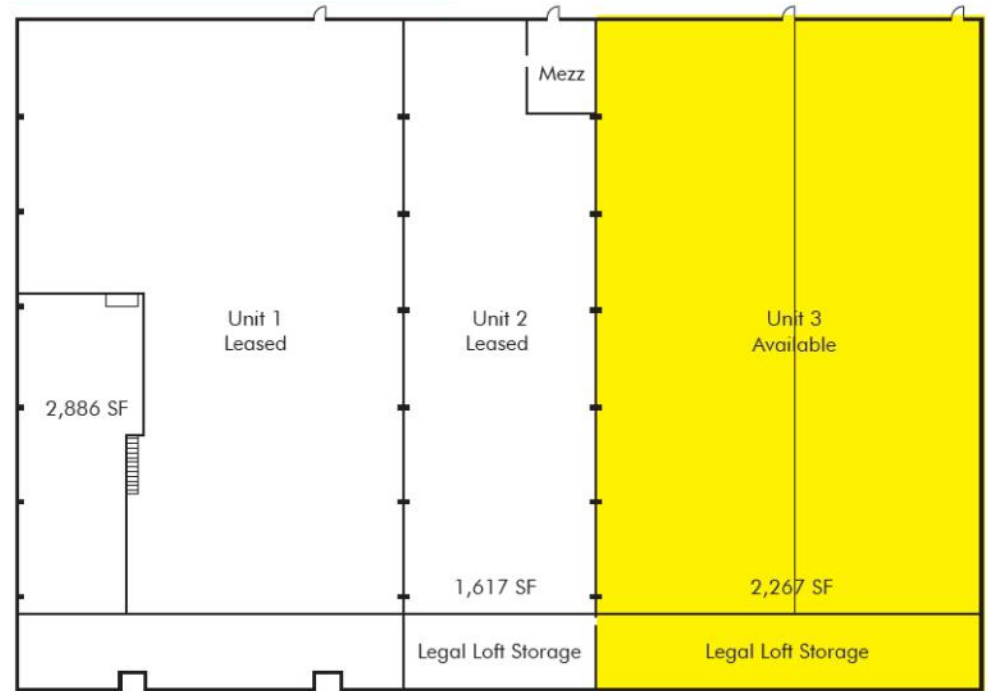

ADDITIONAL PHOTOS



ZONING INFORMATION

Sec. 158.136. Industrial Zoning District (IN).

(A) Purpose. The purpose of the industrial zoning district (IN) shall be to locate and establish areas within the City which are deemed to be uniquely suited for the development and maintenance of industrial activities; to designate those uses and services deemed appropriate and proper for location and development within said zoning district; and to establish such development standards and provisions as are appropriate to ensure proper development and functioning of uses within the district. This district incorporates most of those uses formerly designated heavy industrial (HI), flexible industrial (FI), and light industrial (LI).

(B) Permitted Principal Uses and Structures.

(1) The following principal uses and structures are permitted provided that all businesses, services, manufacturing or processing of materials are confined within a fully-enclosed building with no exterior emission of odors, fumes, dust, smoke, vibration, waste liquids, or other substances:

- a. Manufacturing, assembly, warehousing, storing, processing and packaging of goods and materials.
- b. Research and development facility.
- c. Public or semi-public facility or use.
- d. Television broadcasting station and telephone call centers.
- e. Analytical laboratory.
- f. Warehouse.
- g. Wholesale trade and distribution.
- h. Office space as needed in conjunction with a use listed above.
- i. Retail and business services primarily intended to serve the industrial facilities.

j. Adult entertainment. The applicant must demonstrate consistency with the provisions and conditions of all other pertinent City Code of Ordinances which regulate this use.

k. Facility-based youth day treatment program.

l. Commercial laundry facilities and linen supply.

m. Microbrewery.

n. Repair and maintenance of vehicles and equipment. No storage of vehicles shall be permitted outside of an enclosed building unless an area designated for such use is on the approved site plan and does not reduce the required number of parking spaces for the building. (Doors, including garage doors, may be open during operating hours.

o. Medical Marijuana Dispensing Organizations.

ZONING INFORMATION

(2) The following principal uses which need not be fully enclosed in a building or structure are permitted;

- a. Public utility facility, including water pumping plant, reservoir, and electrical substation.
- b. Warehousing, open storage, provided that all open storage areas shall be completely enclosed by an opaque fence or wall having a minimum height of eight (8) feet with no material placed so as to exceed the height of said fence or wall.
- c. Equipment rental business provided that all open storage areas shall be completely enclosed by an opaque fence or wall having a minimum height of eight (8) feet with no material placed so as to exceed the height of said fence or wall.
- d. Self-service storage facilities in accordance with Section 158.227.

(C) Special Exception Uses. The following uses may be permitted following the review and specific approval by the City Council and serve to implement heavy industrial land uses as contemplated in the Comprehensive Plan:

- (1) Mobile home or apartment for use by custodian or night watchman.
- (2) Disposal and recycling facility for construction and demolition debris, provided that all open storage areas shall be completely enclosed by an opaque fence or a wall having a minimum height of eight (8) feet with no material placed so as to exceed the height of the fence or wall; minimum area required, ten (10) acres.
- (3) Wireless communication antennas and towers, as set forth in section 158.213.
- (4) Recreational vehicle park.

(5) Airport or landing field.

(6) Commercial driving school.

(7) Kennel (enclosed), with outdoor runs.

(8) Other heavy industrial development not listed above but that are considered to have high intensity use with potential impact on surrounding land uses and to be located within heavy industrial land use districts.

(9) Billboards as allowed under 155.08(N).

(10) Solar generation station subject to the requirements of 158.230.

(11) Secondary metals recycler in accordance with Chapter 117.

(12) Cat cafes in accordance with Section 158.235.

TRADE AREA MAP

