

VACANT CORNER INDUSTRIAL LOT

5299 St. Lucie Blvd. Fort Pierce, FL



FOR SALE | \$385,000

**JEREMIAH BARON
& CO**

COMMERCIAL REAL ESTATE

2100 SE Ocean Blvd, Ste 100
Stuart FL, 34994
www.commercialrealestatellc.com

Matthew Mondo
772.286.5744 Office
772.236.7780 Mobile
mmondo@commercialrealestatellc.com

PROPERTY OVERVIEW

- Highly sought-after small industrial lot in St. Lucie County.
- Property is located within a half mile from Treasure Coast Airport, which is process of authorizing commercial flights.
- Mostly cleared parcel with small residential structure onsite.
- Neighboring real estate includes several industrial zoned properties including Maverick Boats & Copart Auto Auctions.
- Equipment or Hydraulic repair business can not be operated on this property.



PRICE	\$385,000
ACREAGE	1.02 AC
FRONTAGE	247' Center Rd, 219' St Lucie Blvd
TRAFFIC COUNT	5,277
ZONING	Industrial
LAND USE	2 Star Industrial
PARCEL ID	1431-212-0004-000-6

NO WARRANTY OR REPRESENTATION, EXPRESS OR IMPLIED, IS MADE AS TO THE ACCURACY OF THE INFORMATION CONTAINED HEREIN, AND THE SAME IS SUBMITTED SUBJECT TO ERRORS, OMISSIONS, CHANGE OF PRICE, RENTAL OR OTHER CONDITIONS, PRIOR SALE, LEASE OR FINANCING, OR WITHDRAWAL WITHOUT NOTICE, AND OF ANY SPECIAL LISTING CONDITIONS IMPOSED BY OUR PRINCIPALS NO WARRANTIES OR REPRESENTATIONS ARE MADE AS TO THE CONDITION OF THE PROPERTY OR ANY HAZARDS CONTAINED THEREIN ARE ANY TO BE IMPLIED.



2100 SE Ocean Blvd, Ste 100
Stuart FL, 34994
www.commercialrealestatellc.com

Matthew Mondo
772.286.5744 Office
772.236.7780 Mobile
mmondo@commercialrealestatellc.com

DEMOGRAPHICS

2024 Population Estimate		2024 Average Household Income		Average Age	
1 Mile	1,177	1 Mile	\$51,223	1 Mile	37.90
3 Mile	19,832	3 Mile	\$47,296	3 Mile	37.30
5 Mile	71,029	5 Mile	\$61,899	5 Mile	42.20

2029 Population Projection		2024 Median Household Income		Median Age	
1 Mile	1,395	1 Mile	\$36,419	1 Mile	36.90
3 Mile	23,811	3 Mile	\$35,956	3 Mile	35.60
5 Mile	86,501	5 Mile	\$46,684	5 Mile	42.10

**JEREMIAH BARON
& CO**

COMMERCIAL REAL ESTATE

2100 SE Ocean Blvd, Ste 100
Stuart FL, 34994
www.commercialrealestatellc.com

Matthew Mondo
772.286.5744 Office
772.236.7780 Mobile
mmondo@commercialrealestatellc.com

ZONING INFORMATION

T. **IL INDUSTRIAL, LIGHT.**

1. Purpose. The purpose of this district is to provide and protect an environment suitable for light manufacturing, wholesale, and warehousing activities that do not impose undesirable noise, vibration, odor, dust, or other offensive effects on the surrounding area, together with such other uses as may be necessary to and compatible with light industrial surroundings. The number in "()" following each identified use corresponds to the SIC Code reference described in Section 3.01.02(B). The number 999 applies to a use not defined under the SIC Code but may be further defined in Section 2.00.00 of this Code.

2. Permitted Uses:

a. Business services. (73)

b. Communications - including telecommunication towers - subject to the standards of Section 7.10.23. (48)

c. Construction services:

(1) Building construction - general contractors. (15)

(2) Other construction - general contractors. (16)

(3) Construction - special trade contractors. (17)

d. Engineering, architectural and surveying services. (871)

e. Commercial fishing. (091)

f. Laundry, cleaning and garment services. (721)

g. Local and suburban transit. (41)

h. Manufacturing:

(1) Food and kindred products. (20)

(2) Tobacco products. (21)

(3) Textile mill products. (22)

(4) Apparel and other finished products. (23)

(5) Furniture and fixtures. (25)

(6) Printing, publishing and allied industries. (27)

(7) Drugs. (283)

(8) Leather and leather products. (31)

(9) Glass:

(a) Flat glass. (321)

(b) Glass and glassware - pressed or blown. (322)

(c) Glass products - made of purchased glass. (323)

(10) Fabricated metal prod. - except machinery and transport. equip.:

(a) Metal cans and shipping containers. (341)

(b) Cutlery, handtools and general hardware. (342)

(c) Heating equipment, except electric and warm air, and plumbing fixtures. (343)

(d) Fabricated structural metal products. (344)

(e) Coating, engraving and allied services. (347)

(f) Miscellaneous fabricated metal products:

**JEREMIAH BARON
& CO**

COMMERCIAL REAL ESTATE

2100 SE Ocean Blvd, Ste 100
Stuart FL, 34994
www.commercialrealestatellc.com

Matthew Mondo
772.286.5744 Office
772.236.7780 Mobile
mmondo@commercialrealestatellc.com

ZONING INFORMATION

- (f) Miscellaneous fabricated metal products:
 - (1) Wire products. (3495)
 - (2) Misc. fabricated wire products. (3496)
 - (3) Metal foil and leaf. (3497)
 - (4) Fabricated metal products - NEC. (3499)
- (11) Industrial/commercial machinery and computer equipment:
 - (a) Metalworking machinery and equipment. (354)
 - (b) Special industry machinery, except metalworking machinery. (355)
 - (c) General industrial machinery and equipment. (356)
 - (d) Computers and office equipment. (357)
- (12) Electronic and other electrical equipment and components, except computer equipment:
 - (a) Household appliances. (363)
 - (b) Electric lighting and wiring equipment. (364)
 - (c) Household audio and video equipment. (365)
 - (d) Communications equipment. (366)
 - (e) Electronic components and accessories. (367)
 - (f) Misc. electrical machinery equipment and supplies. (369)
- (13) Measuring, analyzing and controlling instruments. (38)
- (14) Photographic, medical and optical goods. (38)
- (15) Watches and clocks. (38)
- (16) Misc. manufacturing industries:
 - (a) Jewelry, silverware, and platedware. (391)
 - (b) Musical instruments and parts. (393)
 - (c) Dolls, toys, games and sporting goods. (394)
 - (d) Pens, pencils, and other office and artists' materials. (395)
 - (e) Costume jewelry, costume novelties, and notions. (396)
 - (f) Brooms and brushes. (3991)
 - (g) Signs and advertising displays. (3993)
 - (h) Morticians goods. (3995)
 - (i) Manufacturing industries, NEC. (3999)
- (17) Plastic products - fabrication, molding, cutting, extrusion, and injection processing. (308)
 - i. Marinas. (4493)
 - j. Millwork and structural wood members. (243)
 - k. Motion pictures. (78)
 - l. Motor freight transportation and warehousing. (42)
 - m. Repair services:
 - (1) Automotive and automotive parking. (75)
 - (2) Electrical. (762)

**JEREMIAH BARON
& CO**

COMMERCIAL REAL ESTATE

2100 SE Ocean Blvd, Ste 100
Stuart FL, 34994
www.commercialrealestatellc.com

Matthew Mondo
772.286.5744 Office
772.236.7780 Mobile
mmondo@commercialrealestatellc.com

ZONING INFORMATION

- (3) Watch, clock and jewelry repair. (763)
- (4) Reupholstery and furniture repair. (764)
- (5) Misc. repairs and services. (769)
- n. Retail trade:
 - (1) Lumber and other building materials. (521)
 - (2) Paint, glass and wallpaper. (523)
 - (3) Hardware. (525)
 - (4) Nurseries, lawn and garden supplies. (526)
 - (5) Mobile home dealers. (527)
 - (6) Automotive/boat/RV/motorcycle dealers. (55)
 - (7) Gasoline service. (55)
 - (8) Furniture and furnishings. (57)
- o. Research, development, and testing services. (873)
- p. Ship, boat building and repairing - less than forty-five (45) feet. (373)
- q. Sorting, grading and packaging services - citrus/vegetables. (0723)
- r. Vocational schools. (824)
- s. Wholesale trade - durable goods:
 - (1) Motor vehicle and automotive equipment. (501)
 - (2) Furniture and home furnishings. (502)
 - (3) Lumber and other building materials. (503)
 - (4) Professional and commercial equipment/supplies. (504)
 - (5) Metals and minerals except petroleum. (505)
 - (6) Electrical goods. (506)
 - (7) Hardware, plumbing and heating equipment, and supplies. (507)
 - (8) Machinery, equipment, and supplies. (508)
 - (9) Misc. durable goods:
 - (a) Sporting and recreational goods. (5091)
 - (b) Toys and hobby goods. (5092)
 - (c) Jewelry, watches, precious stones and metals. (5094)
 - (d) Durable goods NEC. (5099)
- t. Wholesale trade - nondurable goods:
 - (1) Paper and paper products. (511)
 - (2) Drugs. (512)
 - (3) Dry goods and apparel. (513)
 - (4) Groceries and related products. (514)
 - (5) Farm products - raw materials. (515)
 - (6) Chemicals, and allied products. (516)
 - (7) Beer, wine, and distilled alcoholic beverages. (518)

**JEREMIAH BARON
& CO**

COMMERCIAL REAL ESTATE

2100 SE Ocean Blvd, Ste 100
Stuart FL, 34994
www.commercialrealestatellc.com

Matthew Mondo
772.286.5744 Office
772.236.7780 Mobile
mmondo@commercialrealestatellc.com

ZONING INFORMATION

- (8) Misc. nondurable goods:
 - (a) Farm supplies. (5191)
 - (b) Books, periodicals and newspapers. (5192)
 - (c) Flowers, nursery stock and florists' supplies. (5193)
 - (d) Tobacco/tobacco products. (5194)
 - (e) Paints, varnishes and supplies. (5198)
 - (f) Nondurable goods, NEC. (5199)
 - u. Mobile food vendors. (999)
 - v. Single-family detached dwelling units provided that the single-family dwelling unit is located on an existing lot or parcel or record, as further defined in this Code, that was existing on or before August 1, 1990. (999)
 - w. Kennels. Allowed as a permitted use only when the property is surrounded by industrial uses or zoning and is five hundred (500) feet or more from residential uses or zoning. All distance requirements shall be measured from the nearest point of the existing home or area of single-family zoning to the nearest point of the proposed kennel.
 - x. Landscape and horticultural services. (078)
 - y. Personal services. (72)
- 3. Lot Size Requirements. Lot size requirements shall be in accordance with Table 7-10 in Section 7.04.00.
- 4. Dimensional Regulations. Dimensional requirements shall be in accordance with Table 7-10 in Section 7.04.00.
- 5. Offstreet Parking and Loading Requirements. Offstreet parking and loading requirements are subject to Section 7.06.00.
- 6. Landscaping Requirements. Landscaping requirements are subject to Section 7.09.00.

**JEREMIAH BARON
& CO**

COMMERCIAL REAL ESTATE

2100 SE Ocean Blvd, Ste 100
Stuart FL, 34994
www.commercialrealestatellc.com

Matthew Mondo
772.286.5744 Office
772.236.7780 Mobile
mmondo@commercialrealestatellc.com

SITE PLAN

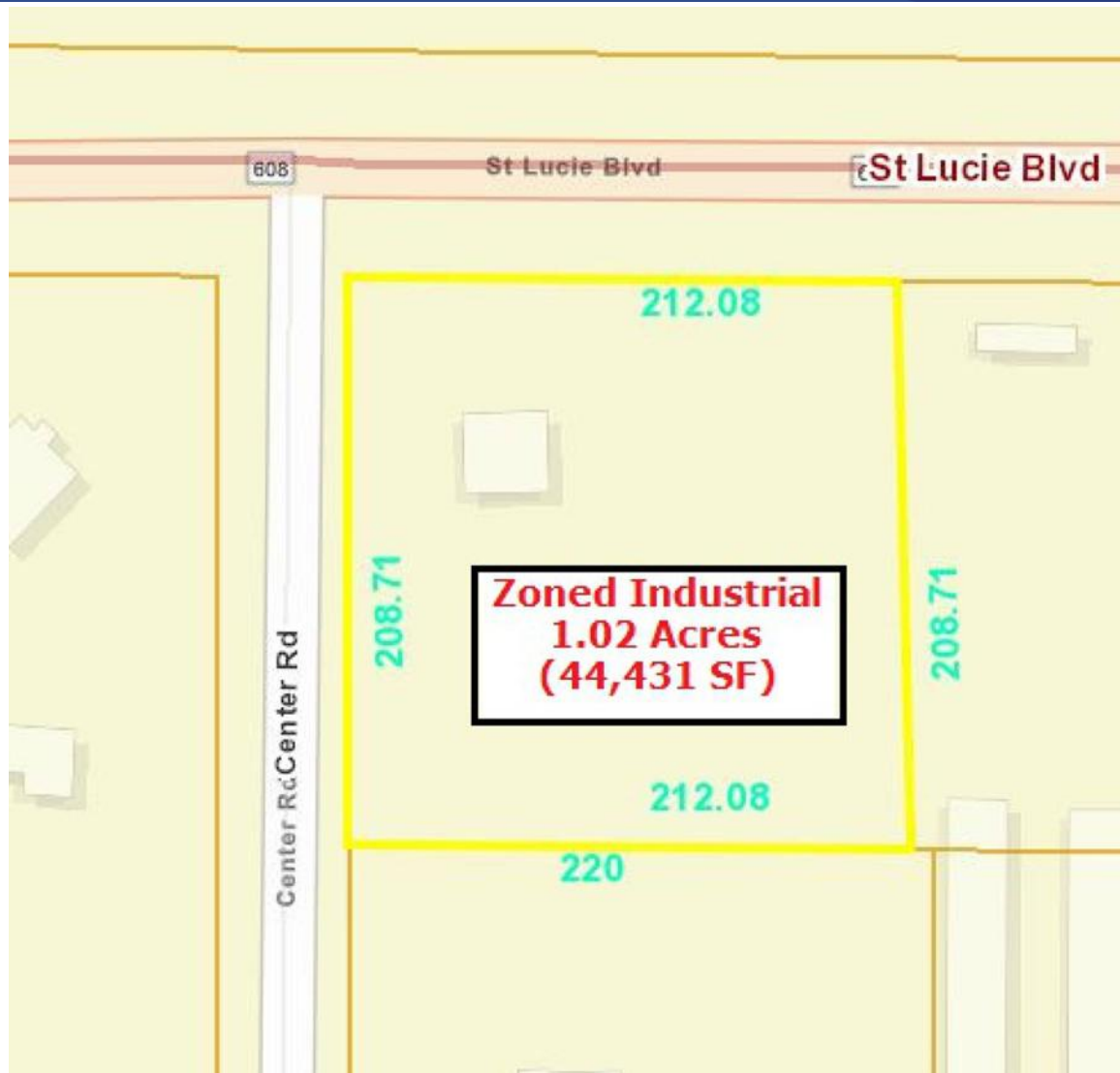

**JEREMIAH BARON
& CO**

COMMERCIAL REAL ESTATE

2100 SE Ocean Blvd, Ste 100
Stuart FL, 34994
www.commercialrealestatellc.com

Matthew Mondo
772.286.5744 Office
772.236.7780 Mobile
mmondo@commercialrealestatellc.com

TRADE AREA MAP



**JEREMIAH BARON
& CO**
COMMERCIAL REAL ESTATE

2100 SE Ocean Blvd, Ste 100
Stuart FL, 34994
www.commercialrealestatellc.com

Matthew Mondo
772.286.5744 Office
772.236.7780 Mobile
mmondo@commercialrealestatellc.com